

SUBMERSIBLE GATE PUMP

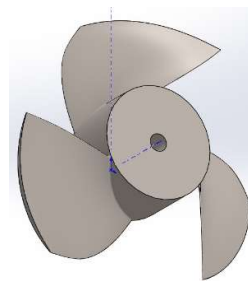
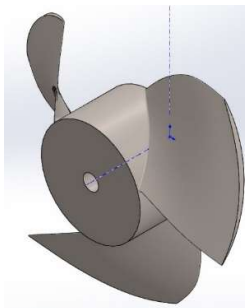
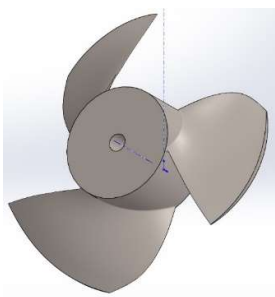

WPIL LIMITED

INTRODUCTION

WPIL Limited, formerly known as Worthington Pump India Ltd., was established about 60 years back and has dedicated itself to the development of complete range of pumps and water handling systems.

Leveraging the hydraulic heritage of the world-famous Worthington and Johnston brand and enhancing it with a sophisticated Research and Development Centre, the Company now possesses an enviable product range of Pumps and capability. Its Horizontal Pump range covers the large engineered Horizontal Split Case and Volute Pumps to the smaller End Suction Pumps.

The Pumps find applications in all spheres of Industry, Power, Irrigation and Municipal Sectors from Raw Water applications, Booster Pump Applications, Cooling Water Applications, Municipal Distribution Applications to Lift Irrigation Applications. These products are the market leaders in performance.

Based on WPIL's huge manufacturing capability including 4 foundries handling various metallurgies, these pumps can be supplied in all metallurgies from simple cast iron construction to exotic super duplex stainless steels and nickel alloys.

WPIL products are backed by a world class after sales team with trained personnel who can be deputed a short notice. Today WPIL is truly an International Company with operations across the Globe.

The Company had following Historical Benchmarks during these long years:

- 1952 Johnston Pumps India - A JV of Johnston, US
- 1983 Worthington Pump India Ltd - JV of Worthington
- 1991 India's largest Cooling Water Pump
- 2003 Start of Turnkey Project Division
- 2010 Manufacture of Concrete and Metallic Volute Pumps
- 2011 Large Turnkey Projects for Water System of Power Plant
- 2011 WPIL International Formed
- 2013 Large order for 30000 KW Volute Pumps



WPIL LIMITED

TYPICAL INSTALLATION ARRANGEMENT OF GATE PUMP:

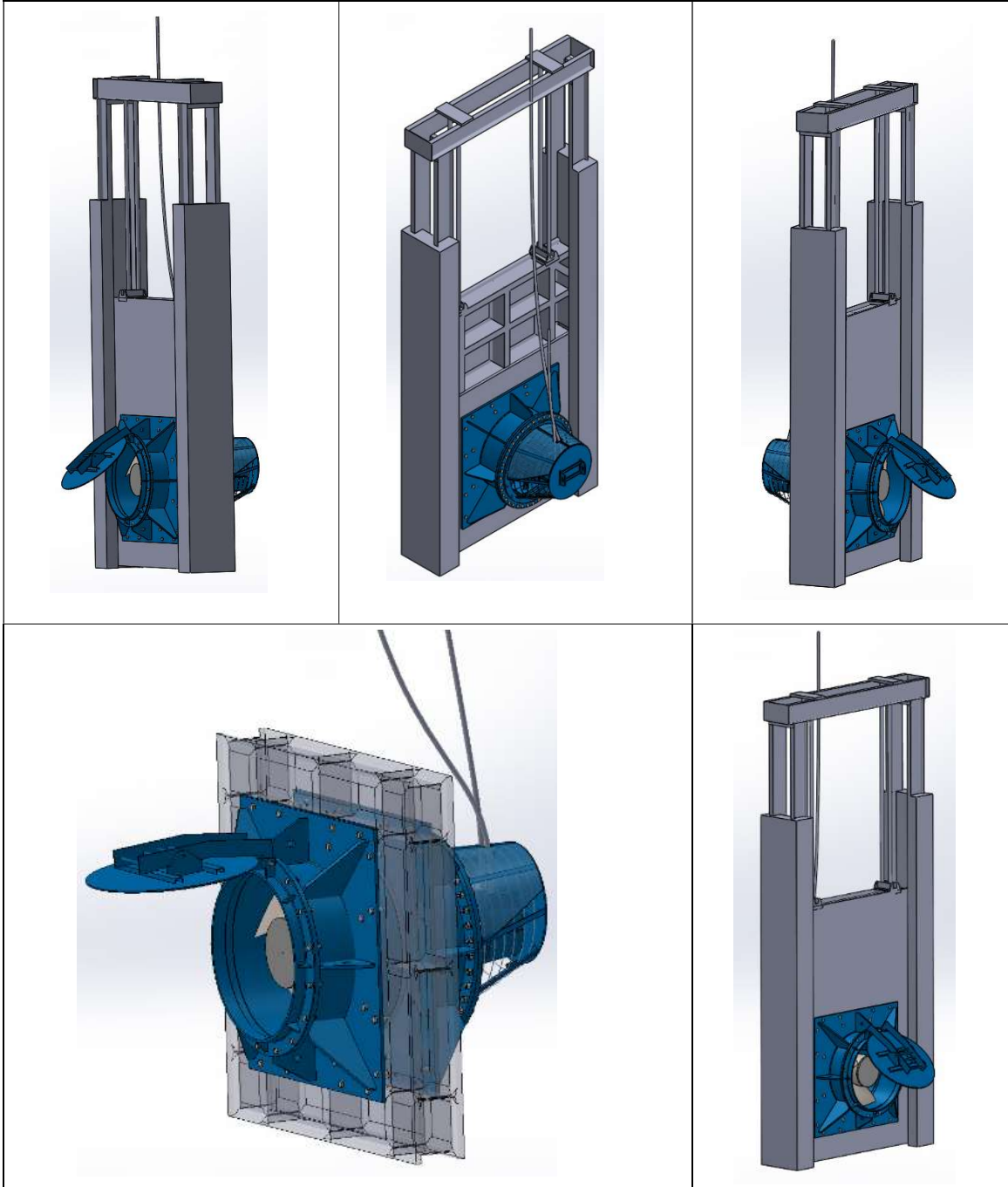

WPIL LIMITED

Coverage of Pumps:

Technical Specifications:

- * Capacities up to 10.0 M³/S.
- * Heads range 1.0 M to 3.0 M.
- * Motors up to 500 kw.
- * Compact unit in mono-block design.
- * Wide range of duties.
- * With wet and dry motor options.

Applications:

- *Control of storm and Flood water.
- *Large capacity Pumping for rapid dewatering.
- *Water level maintaining in low lying area.
- *Filling and emptying water from dry docks and harbour.

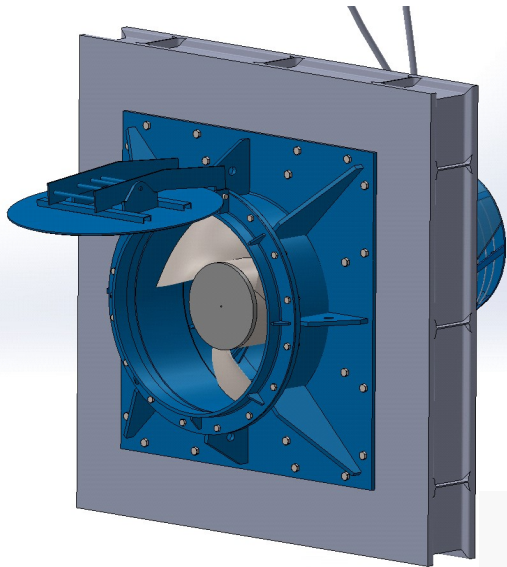
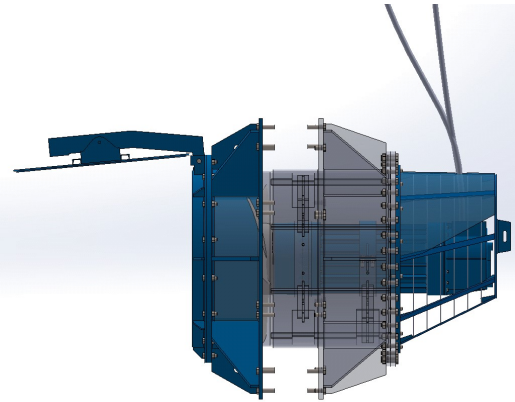

RANGE CHART

HEAD IN MWC

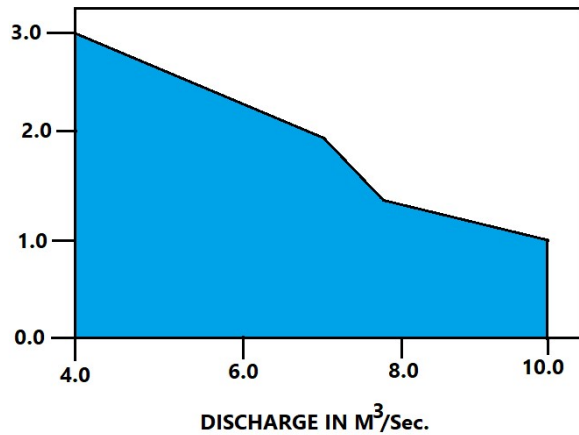

WPIL LIMITED

SUBMERSIBLE GATE PUMP FEATURES & BENEFITS:

Gate Pump: Pumping facilities mounted on structurally fabricated Gate.

Propeller Type: Swept Back propeller does not require any external arrangement for propeller cleaning.

Function: To push water against higher water level on downstream side.

Advantage: Pump Station, Land and Pump House Civil Work: Not required.

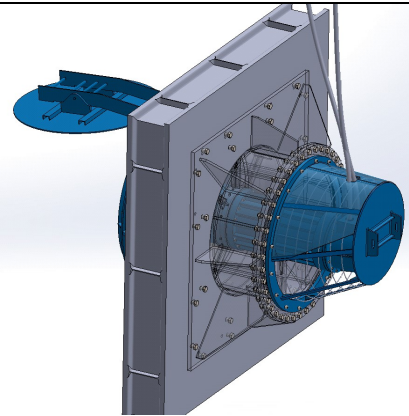
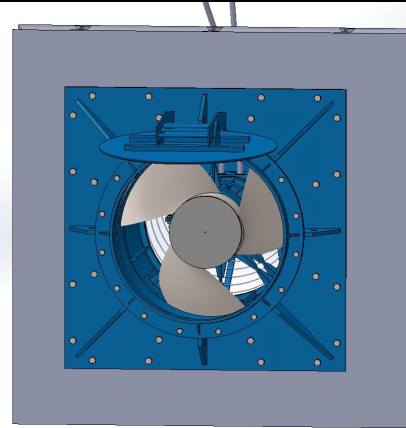

Construction Cost: Substantially less civil and structural cost compared to conventional pump station.

Maintenance Cost: Less electrical & maintenance cost than regular pump station.

Construction Period: Much shorter construction period than normal as construction work is mainly fabrication and simpler.

Existing Gate: Existing gate structure can be re-utilized after modification by installing Gate Pump.

Electrical Power Consumption: 40% ~ 50% of electric consumption less than ordinary pump station.

Suitability for operating at variable system heads: VFD enables to operate at variable speed and hence variable head.

Automation: Automation facility available.

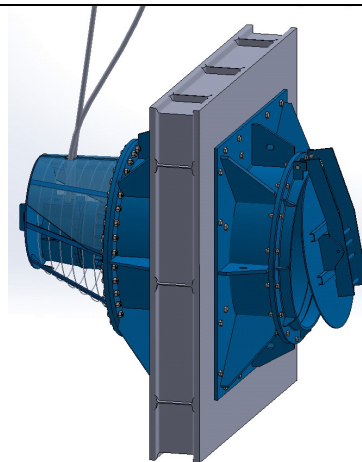

WPIL LIMITED



OUR CONTACTS AVAILABLE IN

KOLKATA, DELHI, MUMBAI, CHENNAI, HYDERABAD, BARODA, BANGALORE, BHUBANESHWAR, BANGKOK, MELBOURNE, JOHANNESBURG, MANCHESTER

CORPORATE & REGISTERED OFFICE

"Trinity Plaza", 3rd Floor, 84/1A, Topsia Road (South),
Kolkata - 700046, (India)
Phone : +91 33 3021 6800
Fax : (91 33) 3021 6835

www.wpil.co.in



WPIL LIMITED